

Proximity induction sensors are all-purpose switches used in machine systems and equipment for no contact surveillance of metal elements motion. They can also be used in other machine systems applications as no contact control sensors for level of liquids, control sensors for the speed and position of rotating chains, etc. They are developed on the base of PNP and NPN transition. They have small dimensions and feature a metal cylindrical shell resistant to vibrations and a plastic lid which is oil and water resistant.

All-purpose proximity switch – series LM xx

- * Insulating resistance: $\geq 50 \text{ M } \Omega$
- * Gearing distance: from 2 mm to 7 mm
- * Precision of repetition: 0.01
- * Ambient temperature: -25°C to $+70^{\circ}\text{C}$
- * Gearing speed: 5mm/s
- * Rated voltage: 6~36VDC; 90~230VAC
- * Protection degree: IP 67

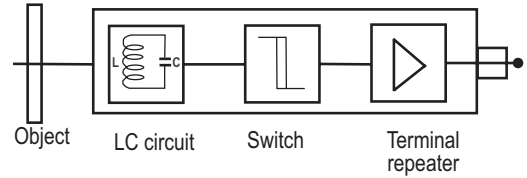

EL-LM8

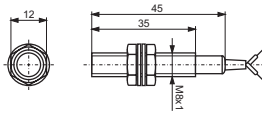

EL-LM12

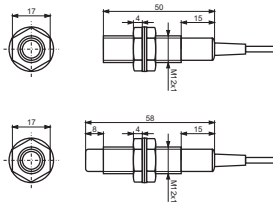

EL-LM18

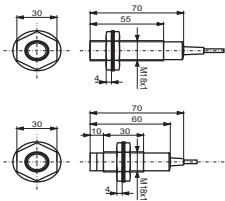

EL-LM22

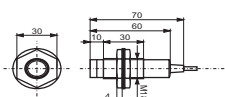
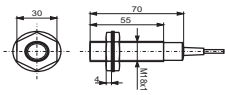
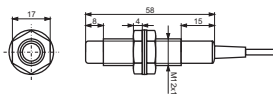
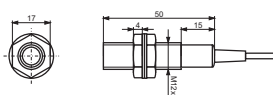
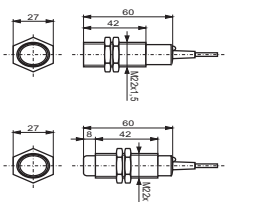

Type	Start distance	Min. size of object	Power supply voltage	Type of transition	Type of contact	Output load	Packing / Box (pcs)	Catalogue number
EL-LM8-3002NA	2 mm	8 x 8 x 1	24 VDC	NPN	NO	130 mA	2 / 200	46LM 8-32NA
EL-LM8-3002NB	2 mm	8 x 8 x 1	24 VDC	NPN	NC	130 mA	2 / 200	46LM 8-32NB
EL-LM8-3002PA	2 mm	8 x 8 x 1	24 VDC	PNP	NO	130 mA	2 / 200	46LM 8-32PA
EL-LM8-3002PB	2 mm	8 x 8 x 1	24 VDC	PNP	NC	130 mA	2 / 200	46LM 8-32PB
EL-LM8-2002A	2 mm	8 x 8 x 1	230 VAC	SCR	NO	150 mA	2 / 200	46LM 8-22A

Type	Start distance	Min. size of object	Power supply voltage	Type of transition	Type of contact	Output load	Packing / Box (pcs)	Catalogue number
EL-LM12-3004NA	4 mm	15 x 15 x 1	24 VDC	NPN	NO	200 mA	2 / 200	46LM 12-34NA
EL-LM12-3004NB	4 mm	15 x 15 x 1	24 VDC	NPN	NC	200 mA	2 / 200	46LM 12-34NB
EL-LM12-3004PA	4 mm	15 x 15 x 1	24 VDC	PNP	NO	200 mA	2 / 200	46LM 12-34PA
EL-LM12-3004PB	4 mm	15 x 15 x 1	24 VDC	PNP	NC	200 mA	2 / 200	46LM 12-34PB
EL-LM12-2004A	4 mm	15 x 15 x 1	1230 VAC	SCR	NO	300 mA	2 / 200	46LM 12-24A

Type	Start distance	Min. size of object	Power supply voltage	Type of transition	Type of contact	Output load	Packing / Box (pcs)	Catalogue number
EL-LM18-3008NA	8 mm	18 x 18 x 1	24 VDC	NPN	NO	200 mA	1 / 100	46LM 18-38NA
EL-LM18-3008NB	8 mm	18 x 18 x 1	24 VDC	NPN	NC	200 mA	1 / 100	46LM 18-38NB
EL-LM18-3008PA	8 mm	18 x 18 x 1	24 VDC	PNP	NO	200 mA	1 / 100	46LM 18-38PA
EL-LM18-3008PB	8 mm	18 x 18 x 1	24 VDC	PNP	NC	200 mA	1 / 100	46LM 18-38PB
EL-LM18-2008A	8 mm	18 x 18 x 1	1230 VAC	SCR	NO	300 mA	1 / 100	46LM 18-28A

Type	Start distance	Min. size of object	Power supply voltage	Type of transition	Type of contact	Output load	Packing / Box (pcs)	Catalogue number
EL-LM22-3010NA	10 mm	22x 22 x 1	24 VDC	NPN	NO	200 mA	1 / 100	46LM 22-30NA
EL-LM22-3010NB	10 mm	22x 22 x 1	24 VDC	NPN	NC	200 mA	1 / 100	46LM 22-30NB
EL-LM22-3010PA	10 mm	22x 22 x 1	24 VDC	PNP	NO	200 mA	1 / 100	46LM 22-30PA
EL-LM22-3010PB	10 mm	22x 22 x 1	24 VDC	PNP	NC	200 mA	1 / 100	46LM 22-30PB
EL-LM22-2010A	10 mm	22x 22 x 1	230 VAC	SCR	NO	300 mA	1 / 100	46LM 22-20A

Type	Start distance	Min. size of object	Power supply voltage	Type of transition	Type of contact	Output load	Packing / Box (pcs)	Catalogue number
EL-LM12-4002A	2 mm	15 x 15 x 1	230 V	inductive	NO	100 mA	2 / 200	46LM 12-44A
EL-LM12-4004A	4 mm	15 x 15 x 1	230 V	inductive	NO	300 mA	2 / 200	46LM 12-46A

Type	Start distance	Min. size of object	Power supply voltage	Type of transition	Type of contact	Output load	Packing / Box (pcs)	Catalogue number
EL-LM18-4006A	5 mm	18 x 18 x 1	230 V	inductive	NO	100 mA	1 / 100	46LM 18-44A
EL-LM18-4008A	8 mm	18 x 18 x 1	230 V	inductive	NO	300 mA	1 / 100	46LM 18-48A