

ISS.	AMEND	DATE
1	1st DRAWN	21/11/12
2	MAT + SPEC ADDED	04/08/14
3	ADD FM1250 + W ERR	12/12/14

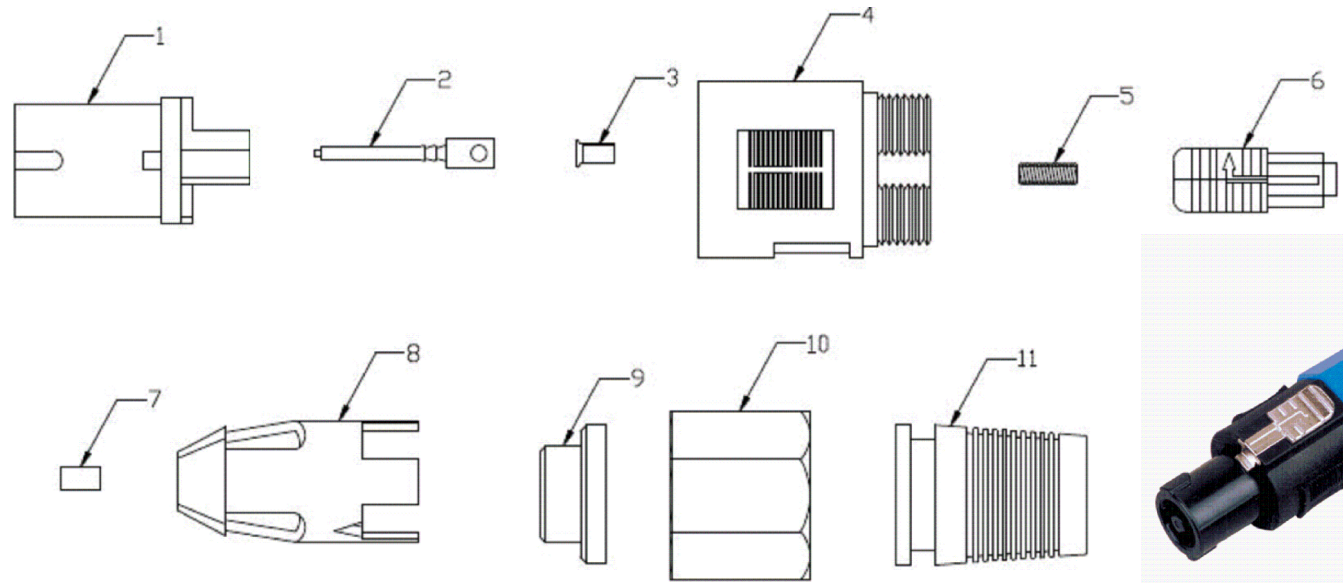

ITEM	MATERIAL	FINISH
1	POLYAMIDE	BLACK
2	COPPER ALLOY	SILVER PLATED
3	STEEL	NICKEL PLATED
4	POLYAMIDE	BLACK
5	STEEL	NICKEL PLATED
6	COPPER ALLOY	NICKEL PLATED
7	COPPER ALLOY	SILVER PLATED
8	PC	BLACK
9	ABS	BLACK
10	ABS	BLUE
11	PVC	BLACK

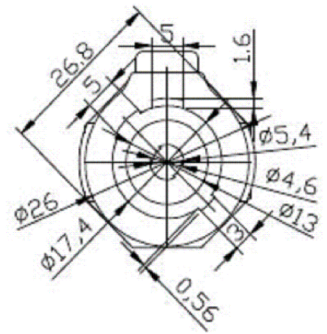
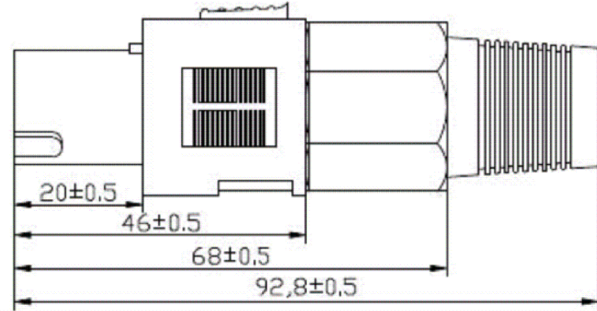
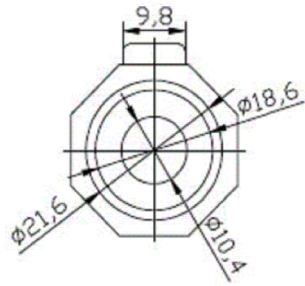

NOTE: 1st ANGLE PROJECTION

FM1250 - AS ABOVE BUT WITHOUT CABLE GROMMET.

SPECIFICATIONS	
Withstanding Voltage	≥ 1400V
Insulation Resistance	≥ 1G Ω
Contact Resistance	≤ 3m Ω
Solderability	≤ 3S
Insertion Force	10-80N
Minimum Life	≥ 2000

RoHS COMPLIANT	
TOLERANCE	
NO DEC. PLACE ±	
1 DEC. PLACE ±	
2 DEC. PLACE ±	
HOLE Ø ±	
ANGLES ±	
UNLESS OTHERWISE STATED	
DO NOT SCALE	

Cliff Electronic Components Ltd.
 76 Holmethorpe Avenue, Holmethorpe Industrial Estate,
 Redhill, Surrey, RH1 2PF, England, UK
 Tel: 01737-771375 Fax: 01737-766012 Website: www.cliffuk.co.uk

THE CONTENTS OF THIS DOCUMENT MUST NOT BE COPIED OR DISCLOSED TO A 3rd PARTY WITHOUT WRITTEN PERMISSION OF CLIFF UK. © 2012

DIMENSIONS IN MILLIMETERS UNLESS OTHERWISE STATED. WORK TO DIMENSIONS. REMOVE ALL BURRS. IF IN DOUBT ASK.

MATERIAL: COMPOSITE

FINISH: CLEAN - BLACK (BLUE NUT)

DRAWN: T.J.O. APPROVED: D.P.J.

1st ANGLE PROJECTION:

TITLE: CLIFFCON-S 4 POLE PLUG WITH GROMMET

DRWG. No. **FM1245** FORM: A4DRWGH