

CH4055-Series

Part Number	Inductance (uH)	Tolerance	Test Freq. of L (KHz)	Q Factor (min)	Test Freq. of Q (MHz)	SRF MHz(min)	DCR (Ω max)	Rated Current (mA)
CH40551R0M-542101-B	1	$\pm 20\%$	1	10	25.2	87.00	0.06	1650
CH40551R2M-542102-B	1.2	$\pm 20\%$	1	20	7.96	81.00	0.06	1625
CH40551R5M-542103-B	1.5	$\pm 20\%$	1	20	7.96	78.00	0.07	1550
CH40551R8M-542104-B	1.8	$\pm 20\%$	1	20	7.96	71.00	0.07	1500
CH40552R2M-542105-B	2.2	$\pm 20\%$	1	20	7.96	61.00	0.08	1450
CH40552R7M-542106-B	2.7	$\pm 20\%$	1	20	7.96	54.00	0.09	1400
CH40553R3M-542107-B	3.3	$\pm 20\%$	1	20	7.96	52.00	0.10	1250
CH40553R9M-542108-B	3.9	$\pm 20\%$	1	20	7.96	49.00	0.11	1200
CH40554R7M-542109-B	4.7	$\pm 20\%$	1	20	7.96	41.00	0.12	1100
CH40555R6M-542110-B	5.6	$\pm 20\%$	1	20	7.96	34.00	0.13	1025
CH40556R8M-542111-B	6.8	$\pm 20\%$	1	20	7.96	28.00	0.14	960
CH40558R2M-542112-B	8.2	$\pm 20\%$	1	20	7.96	24.00	0.15	915
CH4055100K-542113-B	10	$\pm 10\%$	1	50	2.52	22.00	0.16	830
CH4055120K-542114-B	12	$\pm 10\%$	1	45	2.52	20.00	0.17	805
CH4055150K-542115-B	15	$\pm 10\%$	1	45	2.52	18.00	0.19	765
CH4055180K-542116-B	18	$\pm 10\%$	1	40	2.52	16.00	0.21	715
CH4055220K-542117-B	22	$\pm 10\%$	1	35	2.52	15.00	0.24	665
CH4055270K-542118-B	27	$\pm 10\%$	1	35	2.52	13.00	0.27	590
CH4055330K-542119-B	33	$\pm 10\%$	1	30	2.52	11.00	0.30	550
CH4055390K-542120-B	39	$\pm 10\%$	1	25	2.52	10.00	0.34	500
CH4055470K-542121-B	47	$\pm 10\%$	1	25	2.52	9.50	0.43	460
CH4055560K-542122-B	56	$\pm 10\%$	1	20	2.52	8.40	0.50	415
CH4055680K-542123-B	68	$\pm 10\%$	1	25	2.52	7.20	0.62	390
CH4055820K-542124-B	82	$\pm 10\%$	1	20	2.52	6.50	0.69	358
CH4055101K-542125-B	100	$\pm 10\%$	1	20	0.796	6.20	0.85	330
CH4055121K-542126-B	120	$\pm 10\%$	1	35	0.796	5.60	0.94	305
CH4055151K-542127-B	150	$\pm 10\%$	1	45	0.796	5.00	1.3	290
CH4055181K-542128-B	180	$\pm 10\%$	1	40	0.796	4.60	1.5	265
CH4055221K-542129-B	220	$\pm 10\%$	1	45	0.796	4.60	1.9	250
CH4055271K-542130-B	270	$\pm 10\%$	1	35	0.796	4.50	2.3	230
CH4055331K-542131-B	330	$\pm 10\%$	1	50	0.796	3.90	2.7	205
CH4055391K-542132-B	390	$\pm 10\%$	1	45	0.796	3.50	3.0	180
CH4055471K-542133-B	470	$\pm 10\%$	1	45	0.796	2.90	4.0	165
CH4055561K-542134-B	560	$\pm 10\%$	1	70	0.796	2.60	5.1	155
CH4055681K-542135-B	680	$\pm 10\%$	1	60	0.796	2.30	5.8	140
CH4055821K-542136-B	820	$\pm 10\%$	1	55	0.796	2.10	6.6	130
CH4055102K-542137-B	1000	$\pm 10\%$	1	70	0.252	1.80	9.3	125
CH4055122K-542138-B	1200	$\pm 10\%$	1	70	0.252	1.70	10	115
CH4055152K-542139-B	1500	$\pm 10\%$	1	75	0.252	1.50	14	100
CH4055182K-542140-B	1800	$\pm 10\%$	1	70	0.252	1.30	16	90
CH4055222K-542141-B	2200	$\pm 10\%$	1	70	0.252	1.20	22	80
CH4055272K-542142-B	2700	$\pm 10\%$	1	70	0.252	1.10	26	75
CH4055332K-542143-B	3300	$\pm 10\%$	1	70	0.252	1.00	30	70
CH4055392K-542144-B	3900	$\pm 10\%$	1	65	0.252	0.90	42	65
CH4055472K-542145-B	4700	$\pm 10\%$	1	65	0.252	0.85	47	60
CH4055562K-542146-B	5600	$\pm 10\%$	1	65	0.252	0.80	54	55
CH4055682K-542147-B	6800	$\pm 10\%$	1	65	0.252	0.75	60	50
CH4055822K-542148-B	8200	$\pm 10\%$	1	55	0.252	0.65	97	35
CH4055103K-542149-B	10000	$\pm 10\%$	1	25	0.0796	0.60	110	30

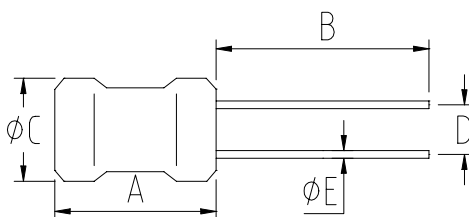

A : 8.0 mm Max

B : 25 \pm 2 mm

C : 5.0 mm Max

D : 2.0 \pm 0.5 mm

E : 0.50 \pm 0.05 mm