

REV.	DESCRIPTION	DRAWN	CHECKED	APPROVED
A	NEW RELEASE	LJH 05/24/05		

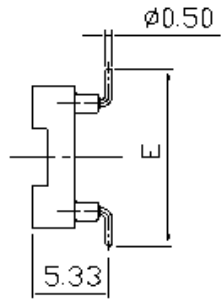

NOTES:

- ELECTRICAL CHARACTERISTICS:
 - CONTACT RESISTANCE: 20mΩ Max. INITIAL.
 - DIELECTRIC WITHSTANDING VOLTAGE: 500V AC(rms) FOR 1 MINUTE.
 - INSULATION RESISTANCE: 1000MΩ Min.
- ENVIRONMENT CHARACTERISTICS:
 - TEMPERATURE: -40°C~+105°C.
- PART NUMBER:
- PRODUCT NUMBER CODE:

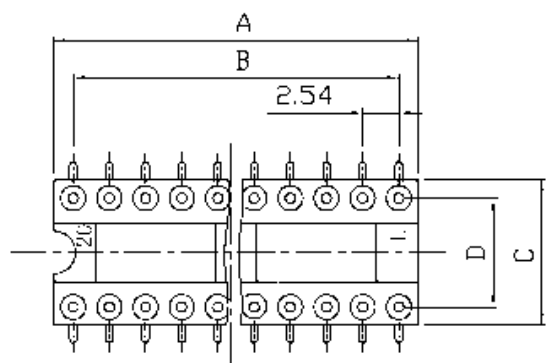
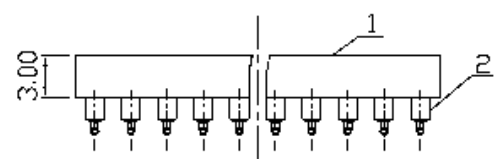

Position	Dimension				
	A±0.5	B±0.2	C	D±0.1	E±0.3
06	7.60	5.08	10.14	7.62	12.42
08	10.16	7.62	10.16	7.62	12.42
14	17.16	15.24	10.16	7.62	12.42
16	20.32	17.78	10.16	7.62	12.42
18	22.86	20.32	10.16	7.62	12.42
20	25.40	22.86	10.16	7.62	12.42
24	30.48	27.94	10.16	7.62	12.42
28	35.56	33.02	10.16	7.62	12.42
24	30.48	27.94	17.78	15.24	20.04
28	35.56	33.02	17.78	15.24	20.04
32	40.62	38.10	17.78	15.24	20.04
40	51.00	48.26	17.78	15.24	20.04

GENERAL TOLERANCE		ANGLE TOLERANCE	
X.	±0.60	X.	±5°
.X	±0.38	X	±3°
.XX	±0.25	.XX	±2°

PROJECTION		TITLE	SMT IC SOCKET PITCH 2.54mm(0.100")
UNITS	mm	SHEET SIZE	A4
SHEET SIZE	A4	SERIES	

ITEM	PART NAME	PART NO.	MATERILAS	FINISHED	DRAWING NO.
2	CONTACT		COPPER ALLOY	GOLD PLATED	DRAWING TYPE
1	HOUSING		THERMOPLASTIC	UL 94 V-0	CUSTOMER
					SCALE
					1:1
					SHEET
					1 OF 1

GOLD-xxP-SMD