

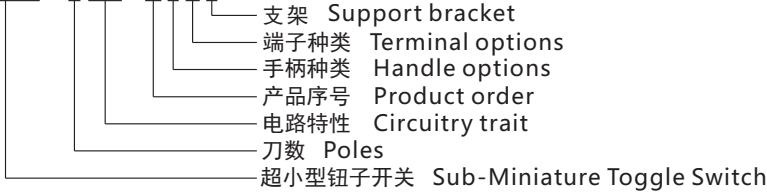

型号说明 Ordering Information

SMTS-102-2C3T



技术特性 Specification

1. 规格 Rating: 3A 125VAC; 1.5A 250VAC
2. 接触电阻 Contact Resistance: 20mΩ max
3. 绝缘电阻 Insulation Resistance: 500VDC 1000MΩ min
4. 耐电压 Dielectric Strength: 1000VAC, 1Minute
5. 操作温度 Operating Temperature: -25°C ~ +85°C
6. 电气寿命 Electrical Life: 10,000 Cycles

电路特性 Circuitry trait

01	ON	-	OFF
02	ON	-	ON
03	ON	OFF	ON

手柄种类 Handle options

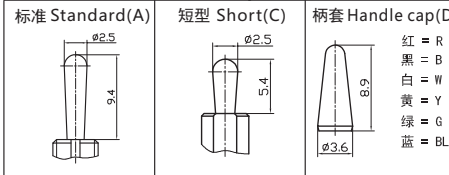

铭牌 Nameplate

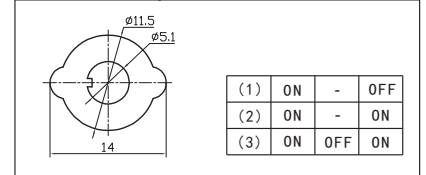

轴套种类 Bushing options

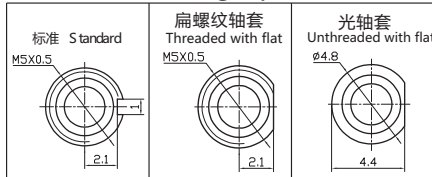

端子种类 Terminal options

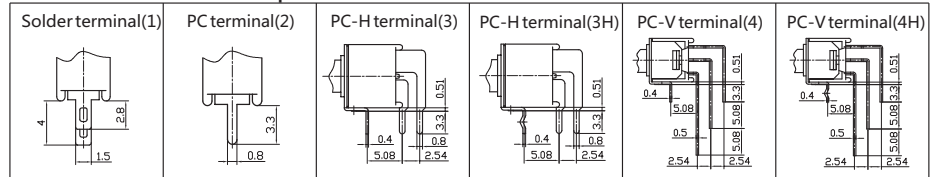

SMTS-101 ON-OFF

SPST 2P

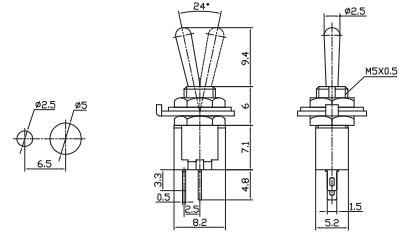

SMTS-102 ON-ON

SPDT 3P

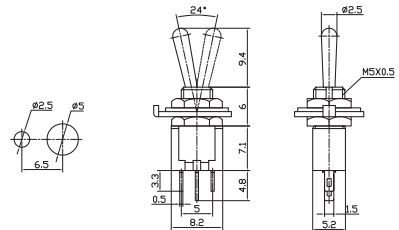

SMTS-202 ON-ON

DPDT 6P

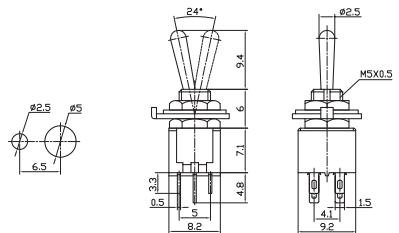

SMTS-101-A2 ON-OFF

SPST 2P

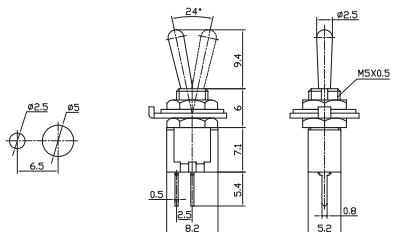



SMTS-102-A2 ON-ON
SPDT 3P

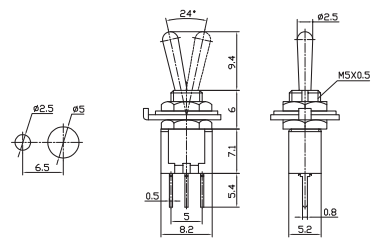

SMTS-202-A2 ON-ON
DPDT 6P

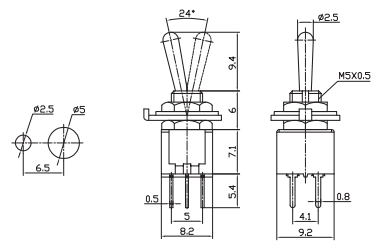

SMTS-101-2A1 ON-OFF
SPST 2P

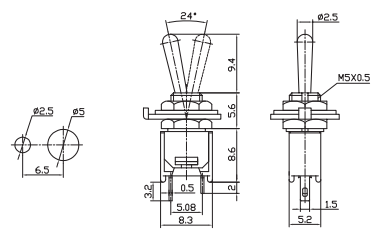

SMTS-102-2A1 ON-ON
SMTS-103-2A1 ON-OFF-ON
SPDT 3P

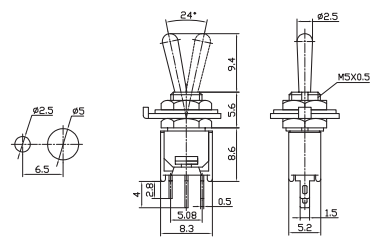

SMTS-202-2A1 ON-ON
SMTS-203-2A1 ON-OFF-ON
DPDT 6P

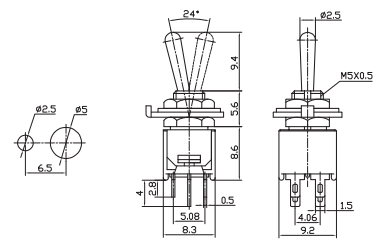

SMTS-102-2C2T ON-ON
SMTS-103-2C2T ON-OFF-ON
SPDT 3P

