

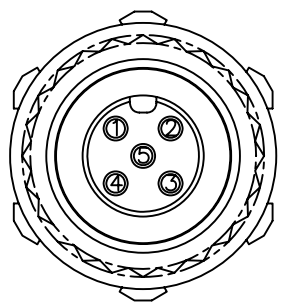

5	6	7	8
REV.	ECN NO.	DATE	SIGN

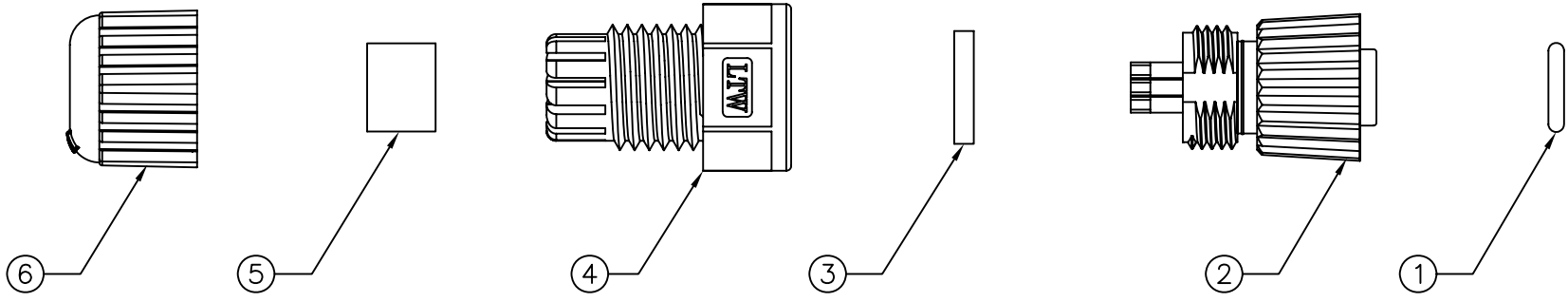

Pin Assignments
Front View

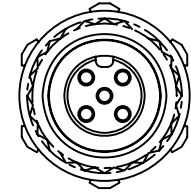
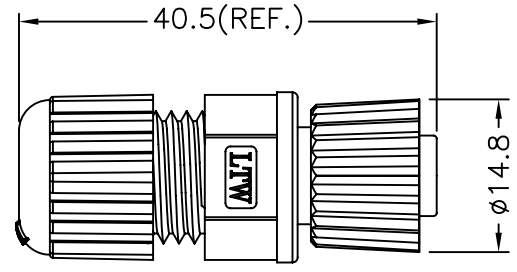

Conn.

Note:

- * Ⓞ Important Dimension To Check.
- * Waterproof Rate: IP68
- * Housing: Black, Nylon+GF
- * Pin: Copper Alloy, Gold Plated
- * Nut: Black, Nylon+GF
- * Ring: Green, Viton
- * Gasket: Black, EPDM
- * Clamp Ring: Black, Nylon
- * Sealing Nut: Black, Nylon
- * Seal: Black, EPDM
- * Seal For Cable OD: $\phi 4.5\text{mm} \sim \phi 6.5\text{mm}$

UNIT:mm		TITLE
TOLERANCE	$\pm 0.5 \text{ mm}$	M12 Conn, Assy Screw 5Pin F Conn. F Pin
SCALE	Free	SHEET 1 OF 1
REV. A	SIZE A4	QC : Inspection Item

LTW

ITEM NO	LTW12P-05BFFA-SL8001	DRAWN BY	Patrick Ian Magat	DATE	2006/12/21
DWG NO	LTW12P-05BFFA-SL8001	CHECKED BY	Alan MJ Sundo	DATE	2006/12/22
CUSTOMER		APPROVED BY	Max Hung	DATE	2006/12/22

THIS INFORMATION IS CONFIDENTIAL AND IS DISCLOSED TO YOU ON CONDITION THAT NO FURTHER DISCLOSURE IS MADE BY YOU TO OTHER THAN LTM PERSONNEL WITHOUT AUTHORIZATION FROM LTM CORP.