

FIG 1:

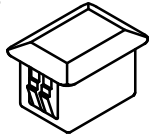

FIG 2:

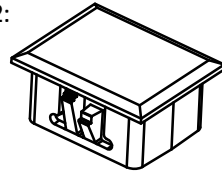
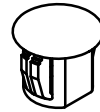

FIG 3:



REV.	MODIFICATION.	DATE	DRN
01	C0-2010730	15/07/09	OW
02	C0-2010780	25/08/09	OW
03	C0-2010881	05/02/10	OW
04	C0-2010984	07/09/10	SF
05	C0-2011040	19/01/11	SF

PART No.	"A"	"B"	"C"	"D"	"E"	"L1"	"L2"	PANEL THICKNESS	FIG	COLOUR
BPE-SC-1-01	21.5 +0.6 -0 [.85 +.024 -0]	12.8 [.50]	12 [.47]	9.3 [.37]	1.5 [.059]	13 [.512]	9.5 [.374]	1.4 - 3.5 [.550 - .138]	1	BLACK
BPE-SC-2-01	16 [.63]									
BPE-SC-3-01	34.8 [1.37]	25.8 [1.02]				26 [1.024]				
BPE-RJ45-01	17.7 [.70]	14.7 [.58]	22 [.87]	19.1 [.75]		19.3-20 [.760-.787]	14.9-15 [.587-.591]	0.75 [.030], 1.2 [.050], 1.6 [.060], 2.7 [.110], 3.5 [.140]	2	GREY
BPE-LC-D-01	15 [.59]	13.2 [.52]	15 [.59]	13.2 [.52]	2 [.078]	13.5 [.532]	13.5 [.532]	0.75 [.030], 1.2 [.050], 1.6 [.060], 2.7 [.110], 3.75 [.148]	1	BLACK
BPE-ST-1-01	Ø12 [.47]	Ø9.2 [.36]	Ø12 [.47]	7.7 [.30]	1.5 [.059]	Ø9.4 [.370]	7.9 [.311]	1.4 - 3.5 [.055 - .138]	3	

FIG 1:

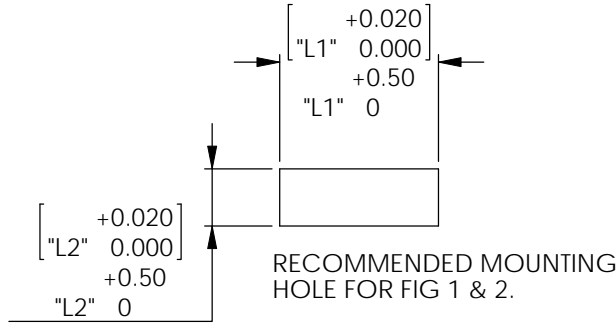
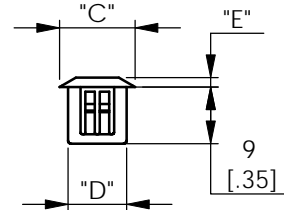
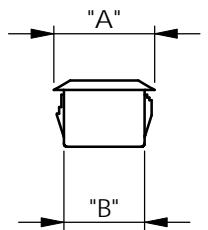

NOTES:
 1) ALTERNATE UNITS FOR REFERENCE ONLY
 2) PARTS AVAILABLE IN OTHER COLOURS BY SPECIAL ORDER
 3) PARTS AVAILABLE IN NYLON 6/6 UL94 V-0(RMS-19) BY SPECIAL ORDER, REPLACE -01 WITH -19 AT END OF PART NUMBER

FIG 2:

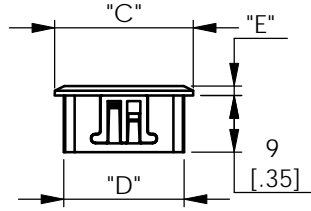
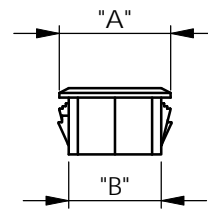
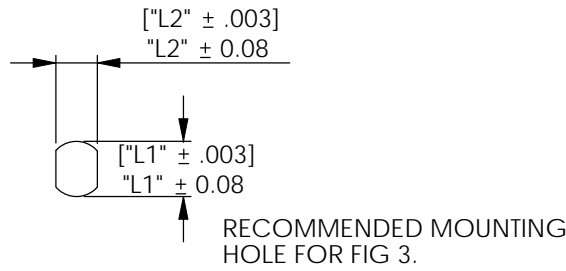
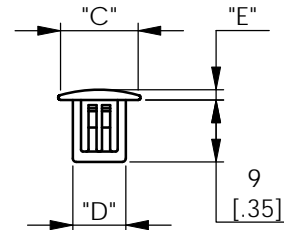
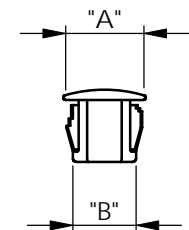

FIG 3:



INFORMATION CONTAINED IN THIS DOCUMENT IS CONFIDENTIAL TO RICHCO INTERNATIONAL Co. Ltd. AND MAY NOT BE DISCLOSED OR REPRODUCED IN WHOLE OR PART WITHOUT THEIR WRITTEN CONSENT.

ALL DIMENSIONS IN mm GENERAL TOLERANCES ±0.25 UNLESS OTHERWISE STATED 1 DECIMAL PLACE ± 2 DECIMAL PLACES ± ANGULAR ±1°		THIRD ANGLE
MATERIAL: NYLON 6/6 UL94 V-2 (RMS-01)		COLOUR: SEE TABLE
DESCRIPTION: BLANKING PLUGS		PART No: SEE TABLE
DRG No: 09-071	NPR No: N/A	SHEET SIZE A4
DRN OW	DATE 15/07/09	CHKD TC
	DATE 15/07/09	SCALE NTS
		SHEET No. 1 OF 1