

# LZ15-G-B

## Features

- 1.Rating: 15A 125/250VAC
- 2.Various actuator are available
- 3.High precision, fast action
- 4.High mechanical strength
- 5.Long life, stable and reliable
- 6.CCC,CE,UL approvals

## Application Area

Widely applied in machinery,production line,elevator equipment etc.

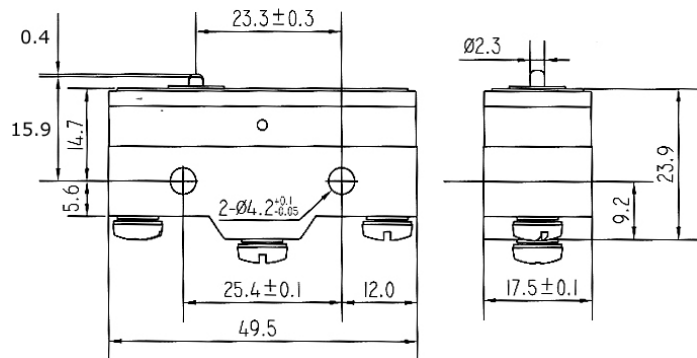

Rating		10A 125/250VAC 0.5A 125VDC
Initial contact resistance		25mΩ max.
Initial insulation resistance		100MΩ min. (at 500VDC)
Dielectric strength	Between non-consecutive terminals	1000Vrms, 50/60Hz for 1 min
	Between non-current carrying metal parts and each terminal	2000Vrms, 50/60Hz for 1 min
	Between ground and each terminal	2000Vrms, 50/60Hz for 1 min
Max.shock resistance	Destruction	1000m/s <sup>2</sup> max.
	Malfunction	300m/s <sup>2</sup> max.
Vibration resistance		10-55Hz, 1.5mm double amplitude
Operating life	Mechanical life	1,000,000 operations min.
	Electrical life	100,000 operations min.
Ambient temperature		-10°C to +85°C
Ambient humidity		95% RH max.
Operating frequency	Mechanical	120 operation/min
	Electrical	30 operation/min
Operating speed		0.01mm-50cm/s
Protection degree		IP65